

LC adapters

Description:

The innovative **LC** design offers a SFF - Small Form Factor one-half the size of current industry standards, and simple features create a new definition of user-friendliness. The **LC** meet EIA/TIA 568A, FOCIS 10 and IEC 11801 specifications for optical performance and intermateability. The **LC** duplex fits into the SC standard cutout.

Two different versions are available:

- Duplex adapters
- Quadruple adapters



Features:

- SFF - Small Form Factor
- Duplex fits SC footprint
- Increases panel density
- Duplex or quadruple design
- Adapter with shutter available

Application:

- Telecom
- LAN, WAN
- CATV
- Sensor systems
- Measuring Technique
- Utilities
- Railways

Ordering code:

A - LC (-D) / (A)PC - XX - XX - YY

| | | |
|--|---|---|
| <p>Type LC-D Duplex LC-D Quadruplex</p> | <p>Sleeve 01 Zirconia 02 Phosphor bronze</p> | <p>Body - XX 01(S¹) SC footprint with flange, metal clip 05(SI¹) SC footprint without flange, metal clip 03 SC footprint with flange, plastic clip 04 SC footprint without flange, plastic clip</p> <p>Type - YY BL Blue (SM) GR Green (SM-APC) BG Beige (MM-OM1,2) TQ Turquoise (MM-OM3) VT Violet (MM-OM4) LG Lime Green (MM-OM5)</p> |
|--|---|---|

Note: 1) With shutter: **S** - Outer shutter
SI - Inner shutter

LC® is trademark of Lucent Technologies, Inc.

Dimensions:

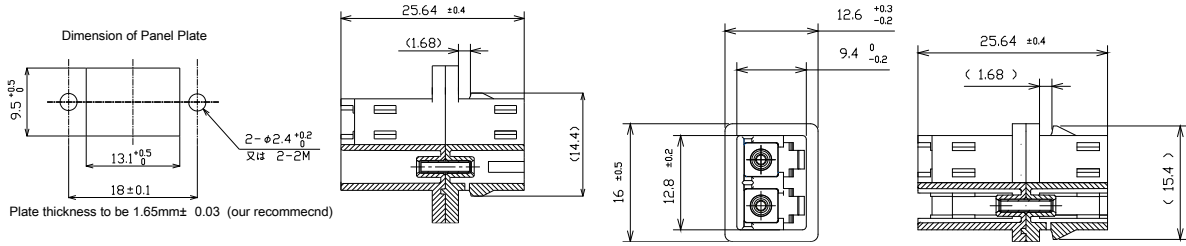

A-LC-D/(A)PC-XX-03 XX

A-LC-D/(A)PC-XX-04 XX

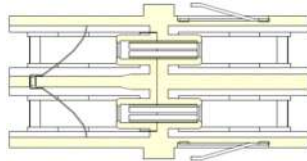

LC duplex adapter with inner shutter
schematic view

A-LC-D/(A)PC-XX-05SI XX

Samples of Adapters:



A-LC-D/PC-01-04-BL



A-LC-D/APC-01-05-GR



A-LC-D/PC-01-05-BL



A-LC-D/PC-02-03-BG



A-LC-D/PC-01-01-BL



A-LC-D/PC-01-01-TQ



A-LC-D/PC-01-01-VT



A-LC-Q/PC-02-03-BG



A-LC-D/PC-01-05S-BL